

IN ACCORDANCE WITH ANSI/APSP/ICC-5 2011, THE INSTALLER IS RESPONSIBLE FOR PLACING ONE SKIMMER FOR EVERY 800 SQUARE FEET OF SURFACE AREA AND ONE RETURN FOR EVERY 300 SQUARE FEET OF SURFACE AREA.

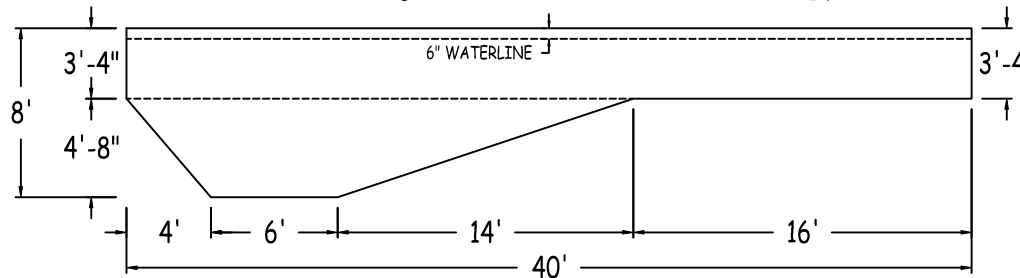
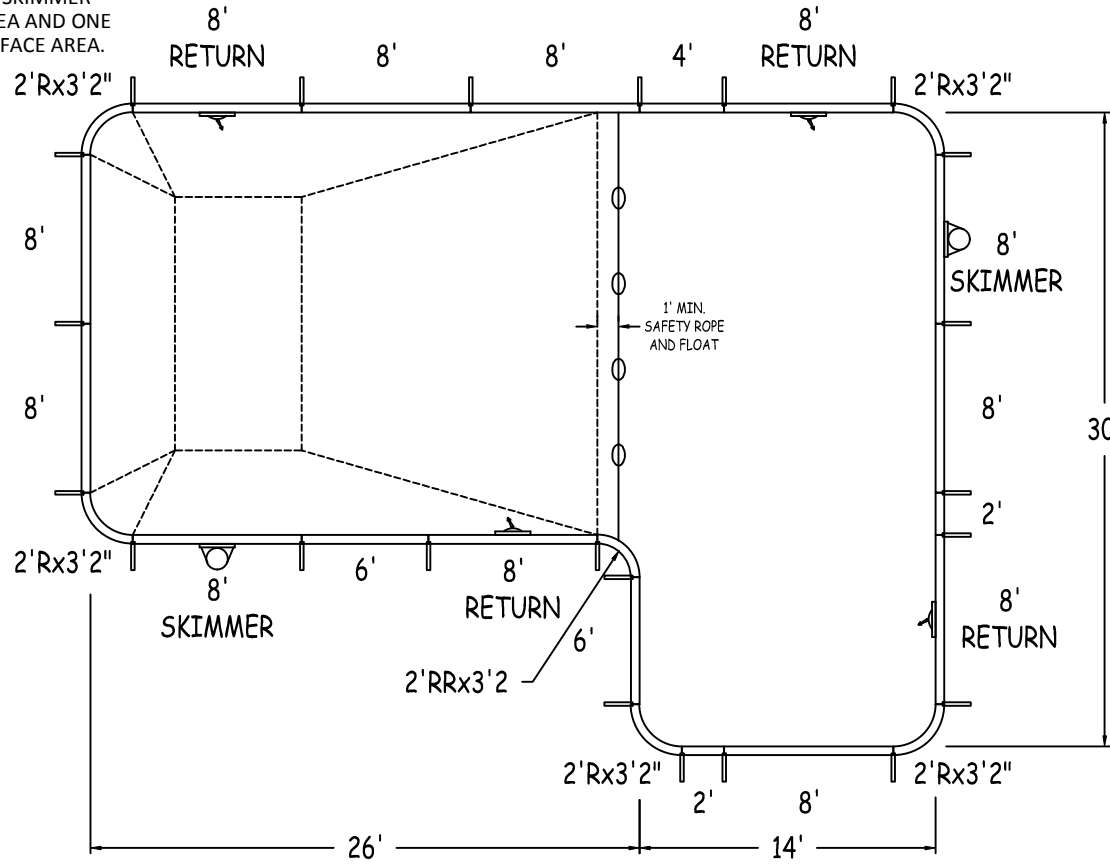
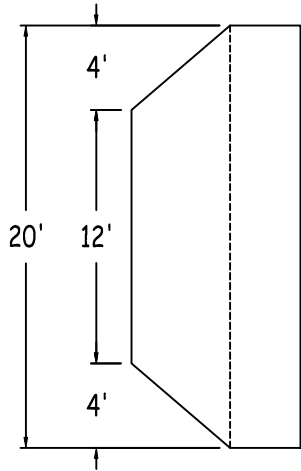

LATHAM STEEL

FULL-L-2FT RAD 20-0 X 30-0 X 40-0 LEFT

42" STEEL PANELS
 DWG#:
USSL24S2040L16
 KIT#:

PERIMETER:	135'-0"	VOLUME (US Gal):	30700
SURFACE (ft²):	937	VOLUME (Liters):	116200
LINER (ft²):	940	DATE:	1/1/2016
		DSR:	136
COVER (ft²):	1084	SCALE:	N/A



DIVING/SLIDING EQUIPMENT SHALL BE DESIGNED FOR SWIMMING POOLS AND SHALL BE INSTALLED IN ACCORDANCE WITH THE DIVING/SLIDING EQUIPMENT MANUFACTURER'S SPECIFICATIONS. PLEASE CONTACT THE DIVING/SLIDING EQUIPMENT MANUFACTURER FOR THEIR SPECIFICATIONS.

MEETS DEPTH AND SHAPE MINIMUM STANDARD ANSI/APSP/ICC-5 2011

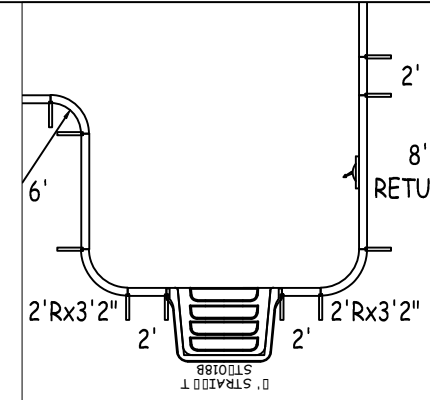

Step Option 1

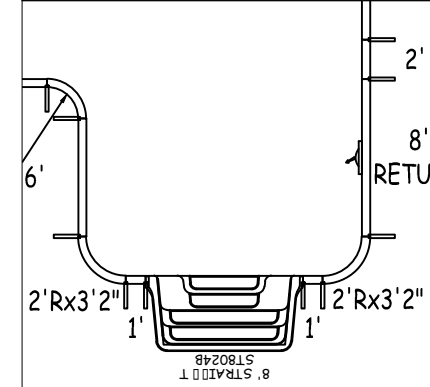

Step Option 2

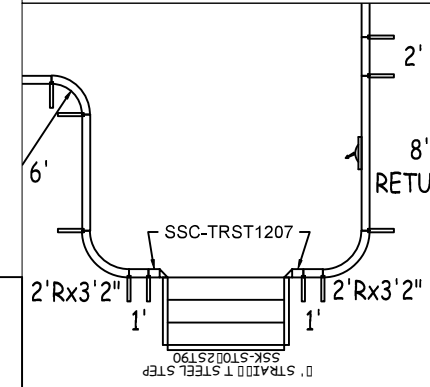

Step Option 3

FULL-L-2FT RAD

SHEET: 1 OF 2

Diagonals	1 to 10	20'-0"	3 to 6	30'-5 1/2"	5 to 6	10'-0"	7 to 10	25'-3 1/2"
S1toS2	1 to 11	18'-1 1/4"	3 to 7	29'-6 1/4"	5 to 7	12'-2"	7 to 11	27'-10 1/4"
H1toH2	1 to 12	2'-10"	3 to 8	24'-5"	5 to 8	14'-5"	7 to 12	36'-9 1/4"
S1toH1	2 to 3	2'-10"	3 to 9	24'-1"	5 to 9	17'-2 1/2"	8 to 9	2'-10"
S2toH2	2 to 4	28'-3/4"	3 to 10	42'-1/2"	5 to 10	37'-4 1/4"	8 to 10	24'-1"
S1toH2	2 to 5	30'-0"	3 to 11	43'-1"	5 to 11	39'-10 1/4"	8 to 11	26'-3 3/4"
H1toS2	2 to 6	31'-7 1/2"	3 to 12	40'-0"	5 to 12	47'-2 1/2"	8 to 12	32'-9 3/4"
1 to 2	2 to 7	30'-5 1/2"	4 to 5	2'-10"	6 to 7	2'-10"	9 to 10	22'-0"
1 to 3	2 to 8	25'-3/4"	4 to 6	12'-2"	6 to 8	8'-3"	9 to 11	24'-1"
1 to 4	2 to 9	24'-5"	4 to 7	14'-0"	6 to 9	10'-9 1/4"	9 to 12	30'-0"
1 to 5	2 to 10	41'-2 1/4"	4 to 8	15'-2 3/4"	6 to 10	27'-10 1/4"	10 to 11	2'-10"
1 to 6	2 to 11	42'-1/2"	4 to 9	17'-10 3/4"	6 to 11	30'-5 1/2"	10 to 12	18'-1 1/4"
1 to 7	2 to 12	38'-3/4"	4 to 10	38'-10"	6 to 12	39'-7 1/4"	11 to 12	16'-0"
1 to 8	3 to 4	26'-0"	4 to 11	41'-2 3/4"	7 to 8	6'-0"		
1 to 9	3 to 5	28'-3/4"	4 to 12	47'-8 1/2"	7 to 9	8'-3"		

Part number	Description	Base	Option 1	Option 2	Option 3
		QTY	QTY	QTY	QTY
ST0960002X	8'	6	5	5	5
ST0960002*	8' SKIMMER	2	2	2	2
ST0960002*	8' RETURN	4	4	4	4
ST0720001X	6'	2	2	2	2
ST0480001X	4'	1	1	1	1
ST0240000X	2'	2	3	1	1
ST0120000X	1'	-	-	2	2
CN0380241X	2'Rx3'2"	5	5	5	5
CR0380240X	2'RRx3'2"	1	1	1	1
SSC-TRST1207	12" Straight Transition	-	-	-	2
Brace	Brace	23	24	24	24
IPC-STKPK25	REBAR STAKE 18" 25PC	2	2	2	2
IPC-HDWSTRT150	BOLT STR 3/8-16X1" C/W NUT 150PC	2	2	2	2
ST6018B	THKSHT STEP STR 6'	-	1	-	-
ST8024B	THKSHT STEP STR SIT N STEP 8'	-	-	1	-
SSK-ST072ST90	STEEL STEP STR-90D 3 TRD 6'	-	-	-	1

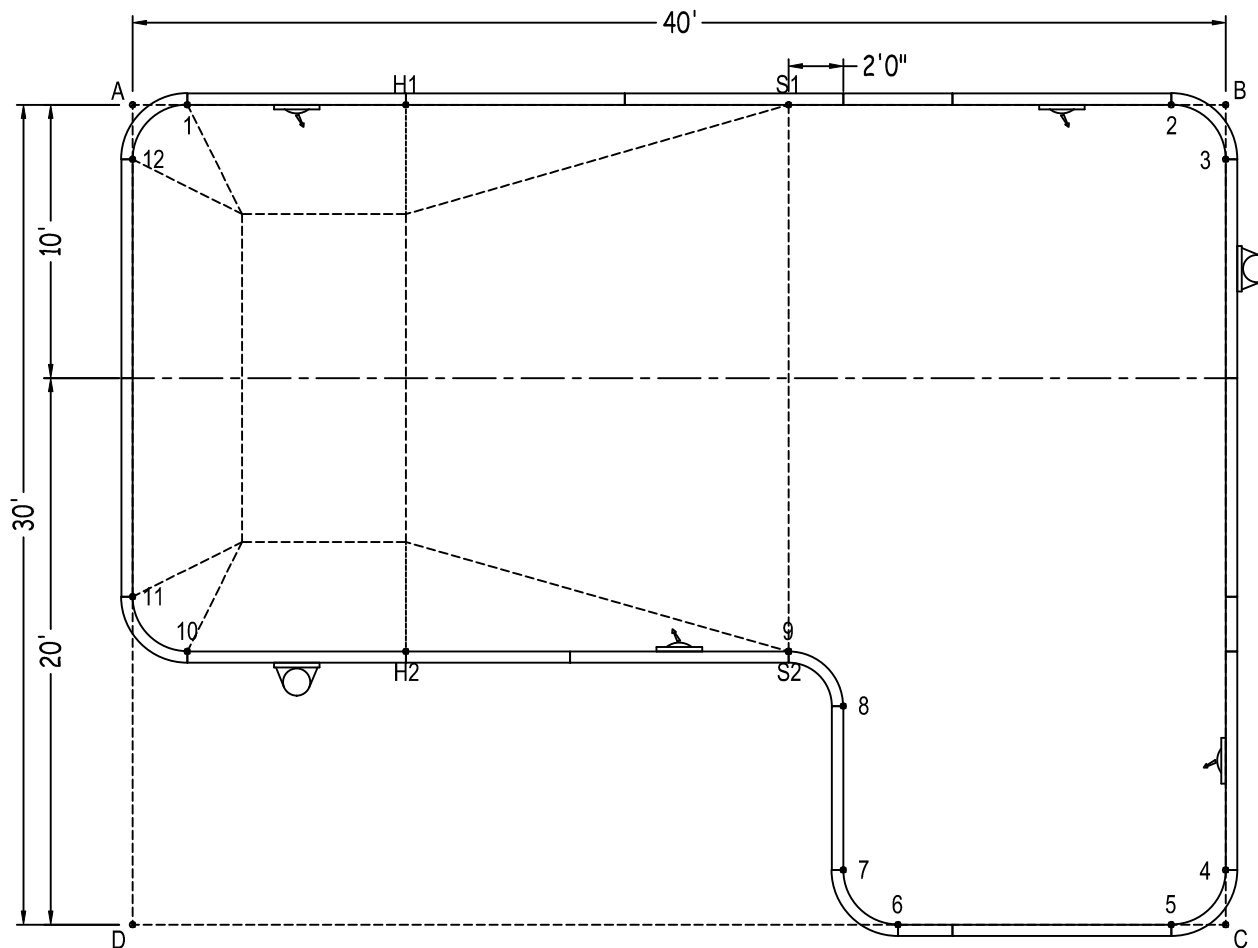

	A	B	C	D
1	2'-0"	38'-0"	48'-5"	30'-3/4"
2	38'-0"	2'-0"	30'-3/4"	48'-5"
3	40'-1/2"	2'-0"	28'-0"	48'-10"
4	48'-10"	28'-0"	2'-0"	40'-1/2"
5	48'-5"	30'-3/4"	2'-0"	38'-0"
6	41'-1/2"	32'-3 3/4"	12'-0"	28'-0"
7	38'-2 1/2"	31'-3 3/4"	14'-1 3/4"	26'-1"
8	34'-3/4"	26'-1"	16'-1 1/2"	27'-2 1/2"
9	31'-3"	25'-7 1/4"	18'-10 1/2"	26'-0"
10	20'-1 1/4"	42'-11 1/4"	39'-3 1/2"	10'-2 1/2"
11	18'-0"	43'-10 1/4"	41'-9 1/4"	12'-0"
12	2'-0"	40'-1/2"	48'-10"	28'-0"
S2	31'-3"	25'-7 1/4"	18'-10 1/2"	26'-0"
S1	24'-0"	16'-0"	34'-0"	38'-5"
H2	22'-4 1/4"	36'-3/4"	31'-7 1/2"	14'-1 3/4"
H1	10'-0"	30'-0"	42'-5"	31'-7 1/2"
A	-	40'-0"	50'-0"	30'-0"

FULL-L-2FT RAD 20-0 X 30-0 X 40-0 LEFT

DWG #: USSL24S2040L16

DATE: 1/1/2016

SHEET: 2 OF 2