

IN ACCORDANCE WITH ANSI/APSP/ICC-5 2011, THE INSTALLER IS RESPONSIBLE FOR PLACING ONE SKIMMER FOR EVERY 800 SQUARE FEET OF SURFACE AREA AND ONE RETURN FOR EVERY 300 SQUARE FEET OF SURFACE AREA.

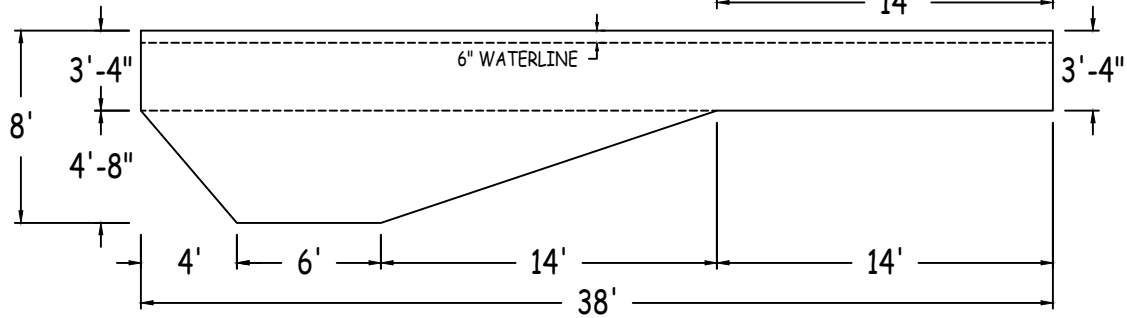
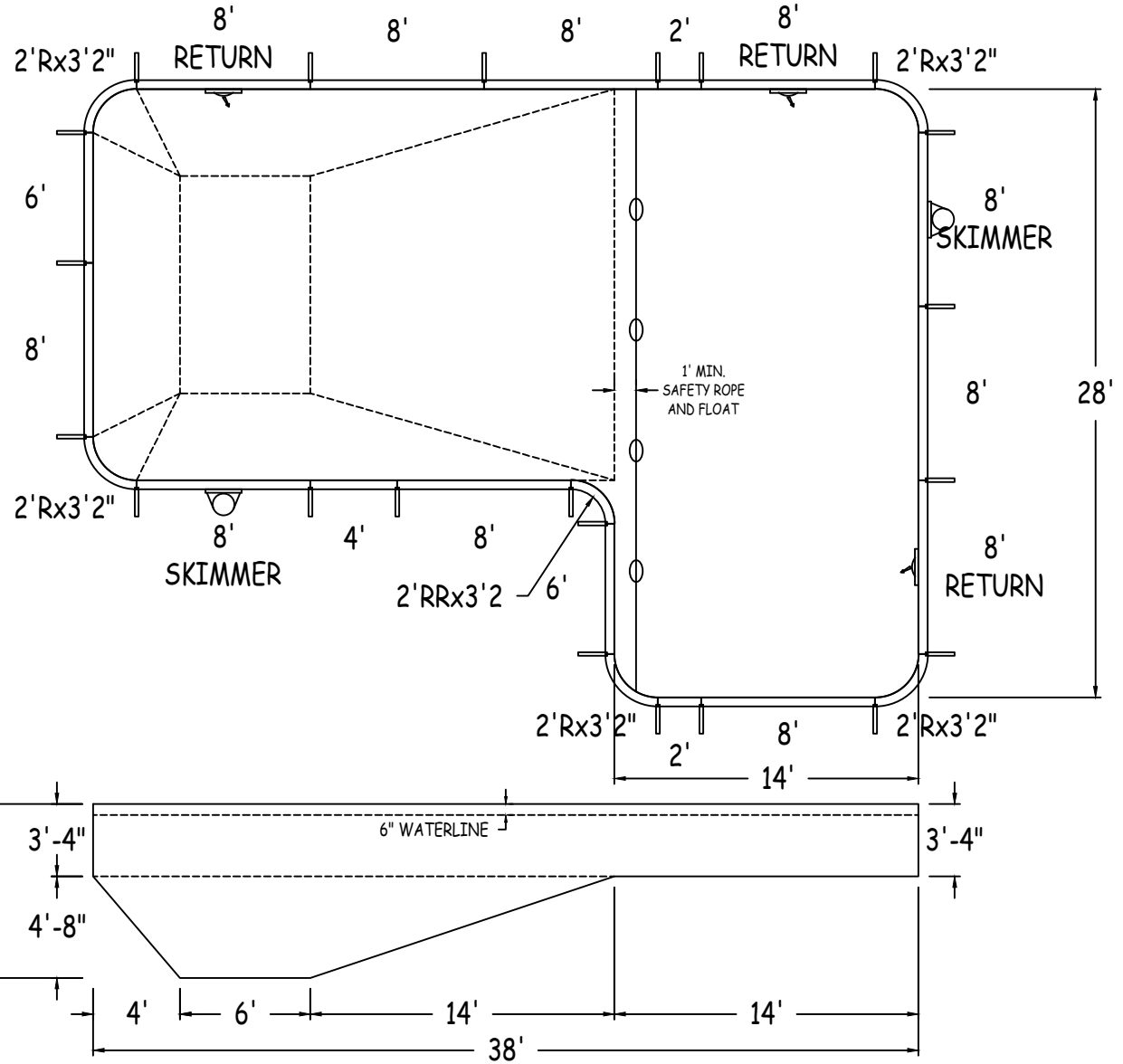
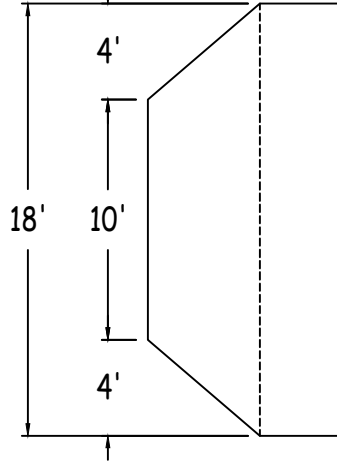

LATHAM STEEL

FULL-L 2FT RAD 18-0 x 28-0 x 38-0 LEFT

42" STEEL PANELS

PERIMETER: 126'-10" VOLUME (US Gal): 26900

DWG#: 2024-SPL-08607

SURFACE (ft²): 821 VOLUME (Liters): 101800

KIT#: CUSTOMKIT

LINER (ft²): 804 DATE: 3/6/2024 DSR:

COVER (ft²): 940

SCALE: 1/8" = 1'-0"



DIVING/SLIDING EQUIPMENT SHALL BE DESIGNED FOR SWIMMING POOLS AND SHALL BE INSTALLED IN ACCORDANCE WITH THE DIVING/SLIDING EQUIPMENT MANUFACTURER'S SPECIFICATIONS. PLEASE CONTACT THE DIVING/SLIDING EQUIPMENT MANUFACTURER FOR THEIR SPECIFICATIONS.

ALL ASPECTS OF THIS DRAWING COMPLIES WITH ANSI/APSP/ICC-5 2011 AND 2015 ISPSC

CUSTOMER: SCP/OLIVE BRANCH

JOB NAME: USSL24S1838L16

FULL-L

Diagonals	1 to 8	29'-8 3/4"	2 to 11	39'-4 3/4"	4 to 7	14'-0"	6 to 7	2'-10"	8 to 11	24'-4"
S1 to S2	1 to 9	26'-11"	2 to 12	36'-3/4"	4 to 8	15'-2 3/4"	6 to 8	8'-3"	8 to 12	30'-0"
H1 to H2	1 to 10	18'-0"	3 to 4	24'-0"	4 to 9	17'-10 3/4"	6 to 9	10'-9 1/4"	9 to 10	20'-0"
S1 to H1	1 to 11	16'-1 1/2"	3 to 5	26'-1"	4 to 10	36'-10 1/2"	6 to 10	26'-0"	9 to 11	22'-1"
S2 to H2	1 to 12	2'-10"	3 to 6	28'-7 3/4"	4 to 11	39'-3 1/2"	6 to 11	28'-7 3/4"	9 to 12	27'-2 1/2"
S1 to H2	2 to 3	2'-10"	3 to 7	27'-9 1/2"	4 to 12	44'-11 1/4"	6 to 12	36'-9 1/4"	10 to 11	2'-10"
H1 to S2	2 to 4	26'-1"	3 to 8	22'-9 3/4"	5 to 6	10'-0"	7 to 8	6'-0"	10 to 12	16'-1 1/2"
1 to 2	2 to 5	28'-0"	3 to 9	22'-7 1/2"	5 to 7	12'-2"	7 to 9	8'-3"	11 to 12	14'-0"
1 to 3	2 to 6	29'-8 3/4"	3 to 10	39'-4 3/4"	5 to 8	14'-5"	7 to 10	23'-5"		
1 to 4	2 to 7	28'-7 3/4"	3 to 11	40'-6"	5 to 9	17'-2 1/2"	7 to 11	26'-0"		
1 to 5	2 to 8	23'-4"	3 to 12	38'-0"	5 to 10	35'-5 1/4"	7 to 12	33'-11 1/4"		
1 to 6	2 to 9	22'-9 3/4"	4 to 5	2'-10"	5 to 11	37'-11 1/4"	8 to 9	2'-10"		
1 to 7	2 to 10	38'-5 3/4"	4 to 6	12'-2"	5 to 12	44'-5"	8 to 10	22'-1"		

		Base
Part number	Description	QTY
ST0960002X	8'	6
ST0960002*	8' SKIMMER	2
ST0960002*	8' RETURN	3
ST0720001X	6'	2
ST0480001X	4'	1
ST0240000X	2'	2
CN0380241X	2'Rx3'2"	5
CR0380240X	2'RRx3'2"	1
Brace	Brace	22
IPC-STKPK25	REBAR STAKE 18" 25PC	2
IPC-HDWSTR150	BOLT STR 3/8-16X1" C/W NUT 150PC	2

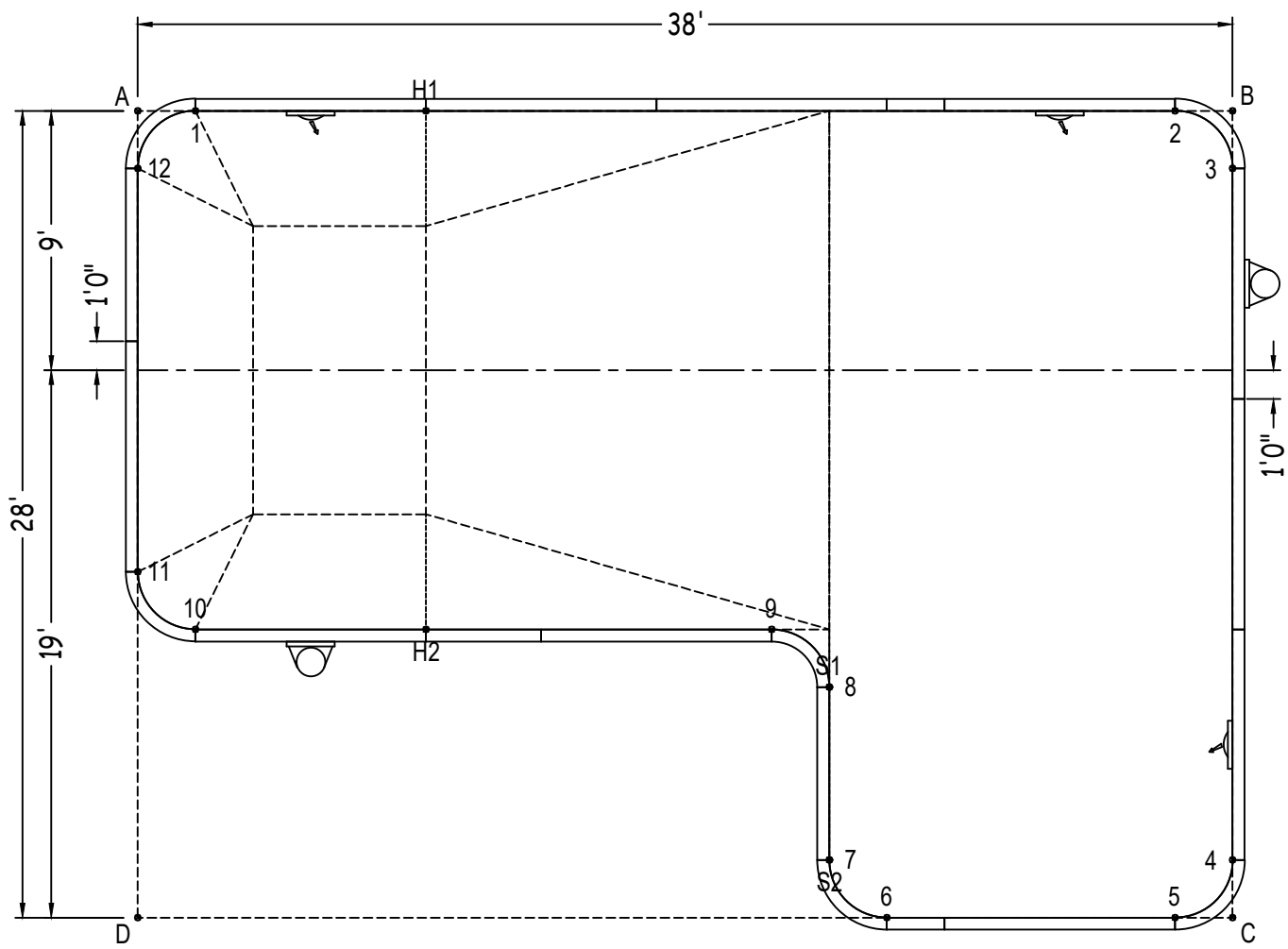

	A	B	C	D
1	2'-0"	36'-0"	45'-7 1/4"	28'-3/4"
2	36'-0"	2'-0"	28'-3/4"	45'-7 1/4"
3	38'-3/4"	2'-0"	26'-0"	46'-1/2"
4	46'-1/2"	26'-0"	2'-0"	38'-3/4"
5	45'-7 1/4"	28'-3/4"	2'-0"	36'-0"
6	38'-2 1/2"	30'-5 1/2"	12'-0"	26'-0"
7	35'-4 1/2"	29'-6 1/4"	14'-1 3/4"	24'-1"
8	31'-3"	24'-5"	16'-1 1/2"	25'-3 1/2"
9	28'-5"	24'-1"	18'-10 1/2"	24'-2"
10	18'-1 1/4"	40'-3"	37'-4 1/4"	10'-2 1/2"
11	16'-0"	41'-2 3/4"	39'-10 1/4"	12'-0"
12	2'-0"	38'-3/4"	46'-1/2"	26'-0"
S2	35'-4 1/2"	29'-6 1/4"	14'-1 3/4"	24'-1"
S1	31'-3"	24'-5"	16'-1 1/2"	25'-3 1/2"
H2	20'-7"	33'-3 1/2"	29'-8 3/4"	14'-1 3/4"
H1	10'-0"	28'-0"	39'-7 1/4"	29'-8 3/4"
A	-	38'-0"	47'-2 1/2"	28'-0"